

# 600# Cast Carbon and Alloy Steel Flanged Fittings

## DIMENSIONS

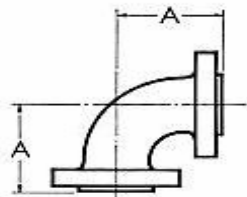

PART # 6EL

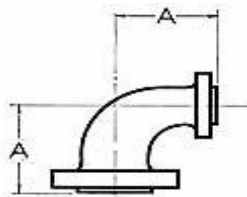

PART # 6REL

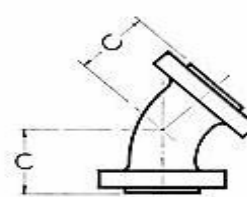

PART # 645

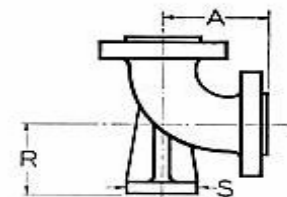

PART # 6ELB

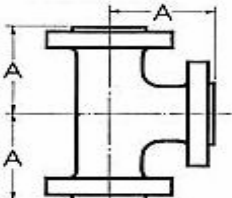

PART # 6T

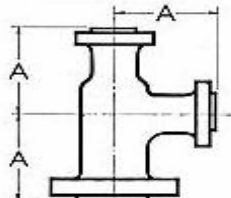

PART # 6RT

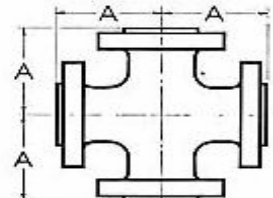

PART # 6CS

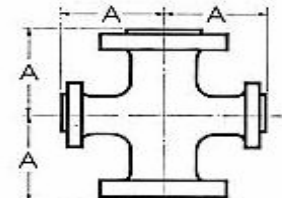

PART # 6RCS

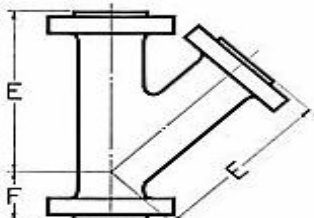

PART # 6LT

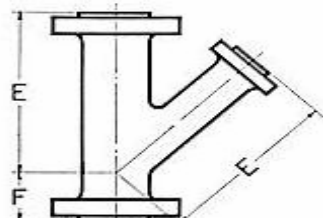

PART # 6RLT

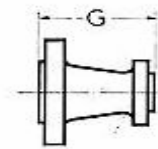

PART # 6CR

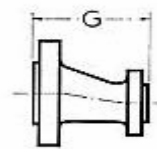

PART # 6ER

All dimensions are in inches

NOMINAL PIPE SIZE	1/2	3/4	1	1 1/4	1 1/2	2	2 1/2	3	3 1/2	4	5	6	8	10	12	14 OD	16 OD	18 OD	20 OD	24 OD
INSIDE DIAMETER OF FITTING	1/2	3/4	1	1 1/4	1 1/2	2	2 1/2	3	3 1/2	4	5	6	7 7/8	9 3/4	11 3/4	12 7/8	14 3/4	16 1/2	18 1/4	22
OUTSIDE DIAMETER OF FLANGE	3 3/4	4 5/8	4 7/8	5 1/4	6 1/8	6 1/2	7 1/2	8 1/4	9	10 3/4	13	14	16 1/2	20	22	23 3/4	27	29 1/4	32	37
MINIMUM THICKNESS OF FLANGE	9/16	5/8	11/16	13/16	7/8	1	1 1/8	1 1/4	1 3/8	1 1/2	1 3/4	1 7/8	2 3/16	2 1/2	2 5/8	2 3/4	3	3 1/4	3 1/2	4
DIAMETER OF RAISED FACE	1 3/8	1 11/16	2	2 1/2	2 7/8	3 5/8	4 1/8	5	5 1/2	6 3/16	7 5/16	8 1/2	10 5/8	12 3/4	15	16 1/4	18 1/2	21	23	27 1/4
DIAMETER OF BOLT CIRCLE	2 5/8	3 1/4	3 1/2	3 7/8	4 1/2	5	5 7/8	6 5/8	7 1/4	8 1/2	10 1/2	11 1/2	13 3/4	17	19 1/4	20 3/4	23 3/4	25 3/4	28 1/2	33
NUMBER OF BOLTS	4	4	4	4	4	8	8	8	8	8	8	12	12	16	20	20	20	20	24	24
SIZE OF BOLTS	1/2	5/8	5/8	5/8	3/4	5/8	3/4	3/4	7/8	7/8	1	1	1 1/8	1 1/4	1 1/4	1 3/8	1 1/2	1 5/8	1 5/8	1 7/8
CENTER TO FACE A ELBOW-TEE-CROSS	3	3 1/2	4	4 1/4	4 1/2	5 1/2	6 1/4	6 3/4	7 1/4	8 1/4	9 3/4	10 3/4	12 3/4	15 1/4	16 1/4	17 1/4	19 1/4	21 1/4	23 1/4	27 1/4
CENTER TO FACE C 45 ELBOW	1 3/4	2 1/4	2 1/4	2 1/2	2 3/4	4	4 1/4	4 3/4	5 1/4	5 3/4	6 3/4	7 1/4	8 1/4	9 1/4	9 3/4	10 1/2	11 1/2	12	12 3/4	14 1/2
CENTER TO FACE E LONG LEG OF LATERAL	5 1/2	6 1/2	7	7 3/4	8 3/4	10	11 1/4	12 1/2	13 3/4	16 1/4	19 1/4	20 3/4	24 1/4	29 1/4	31 1/4	34	38 1/4	41 3/4	45 1/4	52 3/4
CENTER TO FACE F SHORT LEG OF LATERAL	1 1/2	1 3/4	2	2 1/4	2 1/2	3 1/4	3 1/4	3 3/4	4 1/4	4 1/4	5 3/4	6 1/4	6 3/4	7 3/4	8 1/4	8 3/4	9 3/4	10 1/4	10 3/4	12 3/4
FACE TO FACE G REDUCER	4 1/2	4 1/2	4 1/2	4 1/2	4 1/2	5 1/2	6 1/4	6 3/4	7 1/4	8 1/4	9 3/4	10 3/4	12 3/4	15 1/4	16 1/4	17 1/4	19 1/4	21 1/4	23 1/4	27 1/4
R CENTER TO BASE	-	-	-	-	-	4 3/4	5 1/4	5 5/8	6	6 3/4	7 1/2	9	10 1/2	12	13 1/2	14 3/4	16	-	-	-
S WIDTH OF BASE	-	-	-	-	-	6 1/8	6 1/8	6 1/2	6 1/2	7 1/2	10	10	12 1/2	12 1/2	15	15	15	-	-	-

Cast steel flanged fittings are provided with 1/4" raised faces, which are NOT included in minimum thickness of flange, center to face & face-to-face dimensions. Reducing fittings have the same center to face dimensions as those of straight size fittings of the largest opening. Dimensions per ANSI B16.5